

SolarTech Power Solutions

Huawei base station power supply production line



Overview

How Huawei is accelerating the digital transformation of base stations?

Huawei is accelerating the digital transformation of base stations by adopting AI and IoT. Harnessing these digital technologies, 5G Power optimizes coordinated scheduling between various systems, such as power supply modules, site hardware, and the network.

What is Huawei digital power?

According to He Bo, Huawei Digital Power is making continuous innovations in architectures and solutions to help operators thrive as energy prosumers. Single SitePower: Next-Generation Intelligent Architecture for Site Power Facilities Single SitePower is a next-generation intelligent solution architecture for site power facilities.

What makes Huawei a reliable data center?

Reliable: Huawei believes that high-quality and safe lithium batteries should be the top consideration to ensure reliable communication. From general-purpose computing to AI computing, data centers need to resolve four major challenges: reliability, uncertainty, rapid delivery, and high power demand.

Why should you choose Huawei for a power leased site?

Flexible multi-standard output capabilities can ensure power leased sites, covering diverse functions such as security monitoring, disaster detection, and outdoor advertising. With the aim of achieving ubiquitous green connectivity and computing, Huawei is a leader in the digitalization of site power.

What is Huawei 5G power boostli energy storage system?

With the Huawei 5G Power BoostLi energy storage system, Huawei has unlocked greater potential in site energy storage systems. The system provides a three-tier architecture comprising local BMS, energy IoT networking, and cloud BMS.

What are the features of Huawei's network architecture?

The architecture offers three distinct features: Resilient: Huawei integrates wireless networks and site power facility networks to implement grid-source synergy, source-storage synergy, and storage-load synergy, and build resilient facilities throughout the process.

Huawei base station power supply production line



Huawei Reveals a Next-Generation Site Power ...

Mar 4, 2025 · At MWC Barcelona 2025, He Bo, President of Huawei Data Center Facility & Critical Power Product Line, unveiled the next-generation site power ...

Uninterrupted remote site power supply

By Zhang Hongguan & Zhang Yufeng
Uninterrupted power supply for remote base stations has been a challenge since the founding of the wireless industry, but alternative sources have a ...



Huawei 'Ambient Site Enabled AN L4' S

Mar 13, 2025 · Against this backdrop, Huawei launched Ambient Site, an innovative solution that interconnects base station BBUs and RRUs with power supply, transmission, and other ...

HUAWEI DBS3900 Dual-Mode Base Station Hardware ...

Mar 26, 2022 · DBS3900 Dual-Mode Base Station is the fourth generation base station developed by Huawei. It features a multi-mode modular design and supports three working modes: GSM ...



Huawei iSitePower Intelligent Peak Staggering Practice at ...

Jan 7, 2025 · After 5G is deployed, the power consumption and number of base stations increase significantly, and so does the carrier operational expenditure (OPEX). China Tower Zhejiang ...

huawei base station

Dec 23, 2023 · Power Supply Unit (PSU): This provides the necessary electrical power to operate the base station components. It ensures that all parts of the base station have a consistent ...



Innovative Solutions for Efficient huawei base station in ...



Optimize your network with cutting-edge huawei base station that enhances connectivity, boosts efficiency, and ensures reliable communication across vast distances.

Huawei Reveals a Next-Generation Site Power Facility ...

Mar 12, 2025 · Barcelona, Spain
(ANTARA/PRNewswire)- At the Product & Solution Launch during MWC Barcelona 2025, He Bo, President of Huawei Data Center Facility & Critical ...



Digital Power, Issue 04

Dec 25, 2024 · In Hami, a prefecture-level city in western China, comprehensive and systematic grid-forming technology tests have been carried out on the CR Power wind power plant, which ...



Manufacturing Data Center Solution , Huawei Digital Power

Jul 16, 2025 · Manufacturers can save energy and reduce production costs by using an efficient power supply to production lines. Efficient: Consumes less electricity and other resources. ...

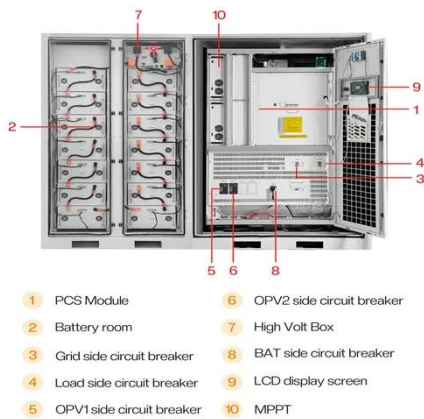

Satellite images reveal Huawei's advanced chip ...

May 4, 2025 · Huawei is building a production line for advanced chips as part of a network of semiconductor facilities in Shenzhen that seeks to break China's ...

Huawei unveils site power facility architecture

Mar 6, 2025 · It adopts a unique three-level synergy mechanism covering site power facilities, wireless networks, and power grids to implement bidirectional interaction of power and ...



2021 Huawei Digital Power SUSTAINABILITY REPORT

Founded in June 2021, Huawei Digital

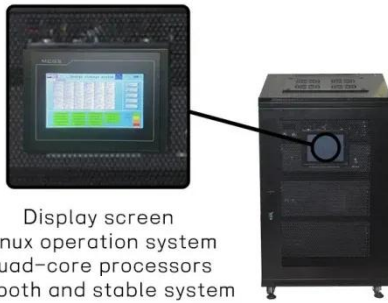

Display screen
Linux operation system
quad-core processors
smooth and stable system

Power Technology Co., Ltd. is a wholly-owned subsidiary of Huawei Technology Co. Ltd. and the world's leading provider of digital power products and ...

Base Station Operation Increases the Efficiency of Network

Under this mode, operators reuse existing wireless station sites, cabinets, power supplies, and backhaul resources, and deploy mini optical line terminals (OLTs).



Contact Us

For catalog requests, pricing, or partnerships, please visit:
<https://posecard.eu>